

# SEF ITALIA



PLANTS FOR SURFACE TREATMENTS



## Plants General Catalogue

MADE IN ITALY



# ABOUT OUR COMPANY

SEF ITALIA is an Italian company specialized in metallic surface treatments.

We continue to apply and increase our specific experience and expertise in the treatment of metal surfaces, particularly focused on aluminum and steel.

Thanks to its decades-long experience, today SEF ITALIA supports the customers towards the optimal solution and every request on surface treatments.

We project and realize:

- *sublimation plants*
- *coating plants for aluminium profiles*
- *coating plants for coils*
- *cleaning plants*

Moreover, we produce the following machines:

- *ultrasound machines for the industrial solvent-free washing of metallic items*
- *US-PATENTED powder coating booth **Magicdisc®***

Flexibility is our key feature. This is possible thanks to our fully automatic, state-of-the-art, computer assisted workshop where our experts will customize several technologies to achieve your goal!



## SEF offers to his clients:



**ENGINEERING**



**CONSTRUCTION**



**ASSISTANCE**

# WHAT WE DO



*SEF ITALIA engineers plants designed to meet the needs of the entire production cycle, from the raw materials to the finished products, using the most performing today's technologies.*

## SEF ITALIA System

*Innovative, flexible and made in Italy*

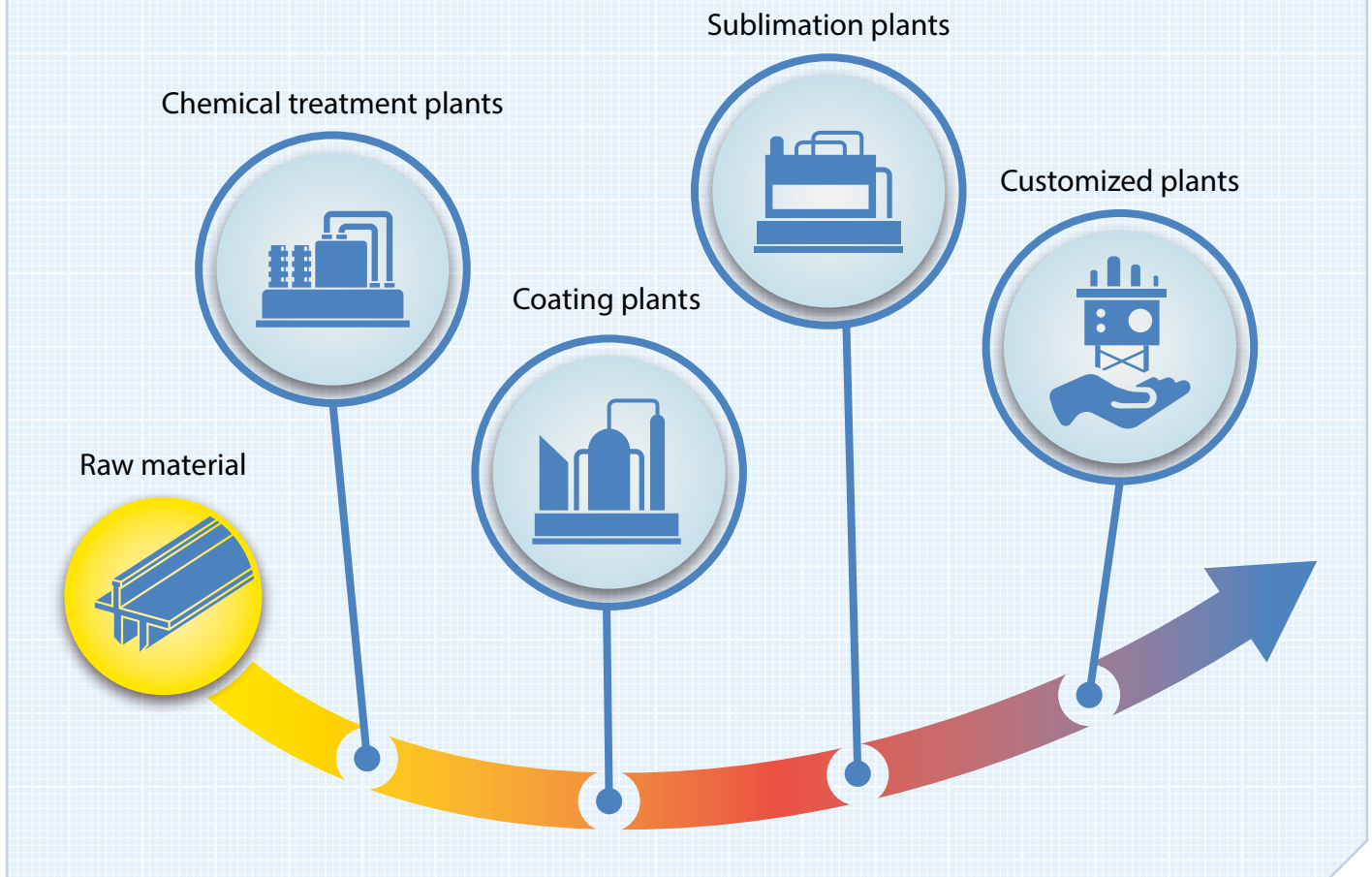

# CHEMICAL TREATMENT PLANTS



*All our coating plants can be equipped with a pre-treatment area, in line with the painting area, so the profiles are not manipulated during the process and they reach the painting step completely clean and bright.*



The innovation in SEF ITALIA equipment dwells in the **continuity between the pre-treating and the painting phase** (chromating or oxydation processes).

The main advantages of such continuous process design are:

- **workforce reduction:**  
*the profiles don't have to be unloaded between the pre-treatment and the painting line. Less profiles handlings mean less costs and fewer workers!*
- **quality improvement:**  
*no profiles handlings leads to flaws-free process and higher cleanliness and gloss!*
- **machine room optimization:**  
*SEF's compact-design leads to a huge saving in floor consumption, compared with the traditional solution of a separate pre-treatment plant and a horizontal coating line!*

In SEF's pre-treating plants, it is possible to install the classical chromating pre-treatment or an **innovative pre-treatment system using anodic oxidation**. Such technology applies onto the metal surface a thin layer of 6-8 micron

of oxidated layer.

The formation, on the surface of aluminium, of one layer of oxide is the best protection against each type of corrosion.

In particular the anodic oxidation is a very performing alternative against the traditional chromating and phosphochromating treatments because it allows:

- *to stop and prevent the formation of the so called "string corrosion"*
- *to protect the aluminium from most of the corrosive atmospheric agents*



# POWDER COATING PLANTS

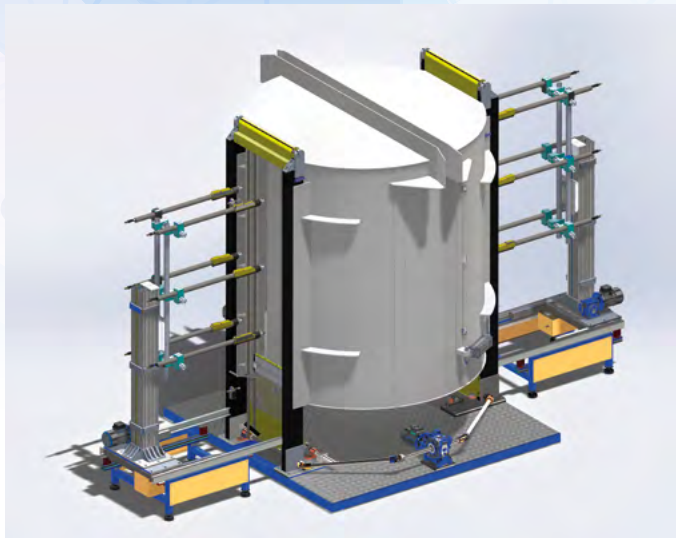

*SEF ITALIA is the leading Italian company specialized in metallic surface treatments. It is impossible to design and customize a surface process plant without a deep knowledge of all technologies involved in the process. The experience gained after years of successful installations around the world is the undeniable certification of the reliability of our plants under the chemical, mechanical and electrical point of view.*

We produce compact powder coating plant for aluminium profiles, boasting innovative features such as:

- **productivity:** up to 1.000 - 1.200 kg/h, almost double of traditional compact plants
- **compact lay-out:** our oven is smaller than the traditional ovens available on the market
- **plant room optimization:** profiles build up area are placed in optimized positions, allowing the operators to manage the loading and the testing operations of the coating booth
- **power consumption:** SEF plants requires a smaller amount of energy when compared to traditional horizontal coating plants

Our plants are equipped with the **patented technology MAGICDISC®**. Basically, one booth is in operation while the other one can be easily cleaned, in order to be ready for the next color! **MAGICDISC®** is the **only self-cleaning coating booth!** This patented extraordinary new invention, thanks to an innovative and easy technological concept, provides the ultimate solution to the critical problem of how to clean the coating booths automatically. SEF has the answer: in 3-5 minutes the booth cleans itself automatically, changing the color with no powders waste and keeping the plant area cleaner.

**SEARCHING FOR AN IMPROVEMENT?  
ASK THE EXPERTS: ASK SEF!**

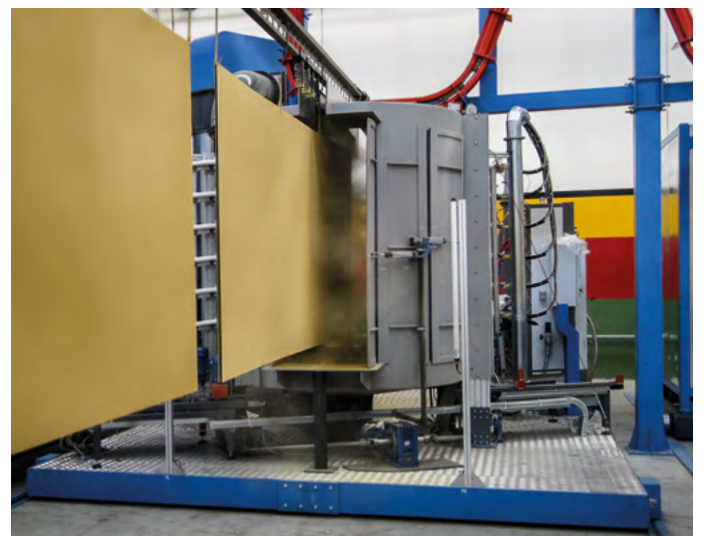

# LIQUID COATING PLANTS



*We produce liquid coils coating plants for aluminium and steel coils.  
SEF ITALIA plants can handle coils in the maximum width of 1.5 meters, thickness between 0.2 mm and 0.8 mm and coil diameters up to 1.8 meters OD.*



Our plants, using the best updated technological solutions, are engineered to meet customer needs in terms of space, material to be coated and user friendly control devices.

Coil coating lines generally available on the market represent a relevant investment, so not every company can take this step lightly. SEF coating lines, on the contrary, are engineered with a very light and easy-to-scale-up approach, making them the perfect solution for entry-level investments, without compromising on quality and machine reliability.

**SEARCHING FOR FLEXIBILITY?  
ASK THE EXPERTS: ASK SEF!**



# LIQUID & POWDER COATING PLANTS



*Thanks to its skills and experience, SEF ITALIA is able to supply coating plants that combine both liquid and powder technology in one machine.*

*This is the perfect solution for today's flexible but demanding market, where powder coating technology is expected to replace a part of the liquid coating market.*

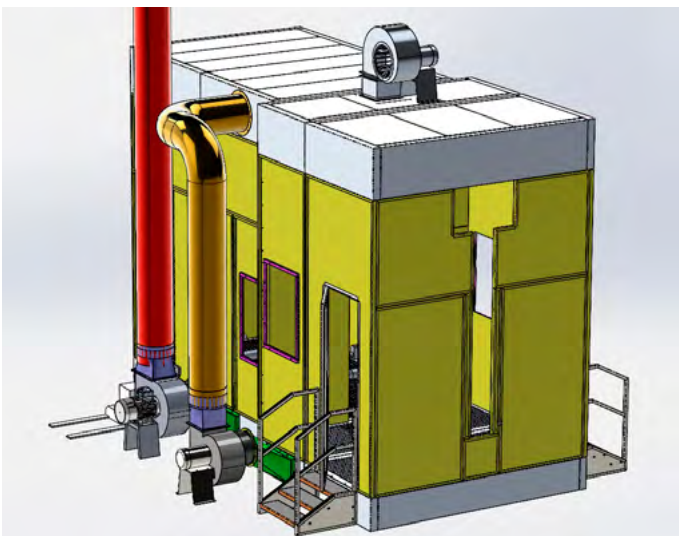

The idea is simple yet efficient: sharing the common parts of every coating plants – loading and unloading area, curing oven, pre-treatment – and adding the parts of a regular liquid and powder plant.

- *The number of painting booths can be customized according to the requested production rate and coating cycle procedures.*
- *Manual re-adjust areas can be inserted to achieve a perfect coating quality.*
- *Each zone of the coating plant has an easy access to allow a convenient and accurate cleaning.*

This solution maximizes the advantages and the versatility of two plants with the footprint of one !





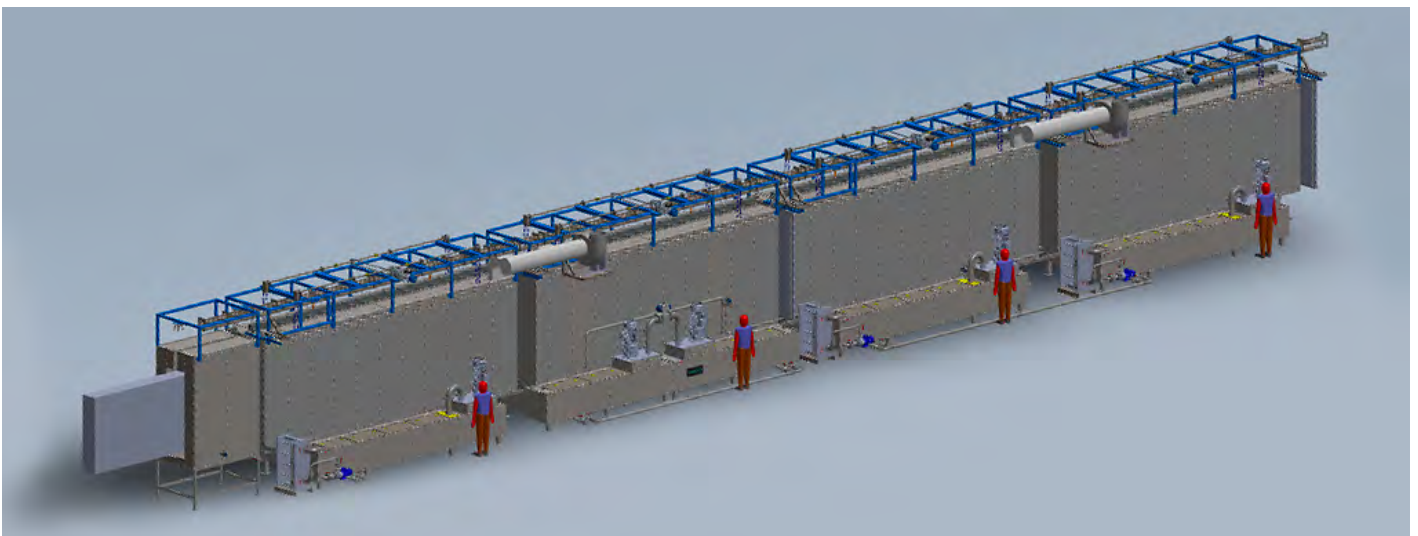
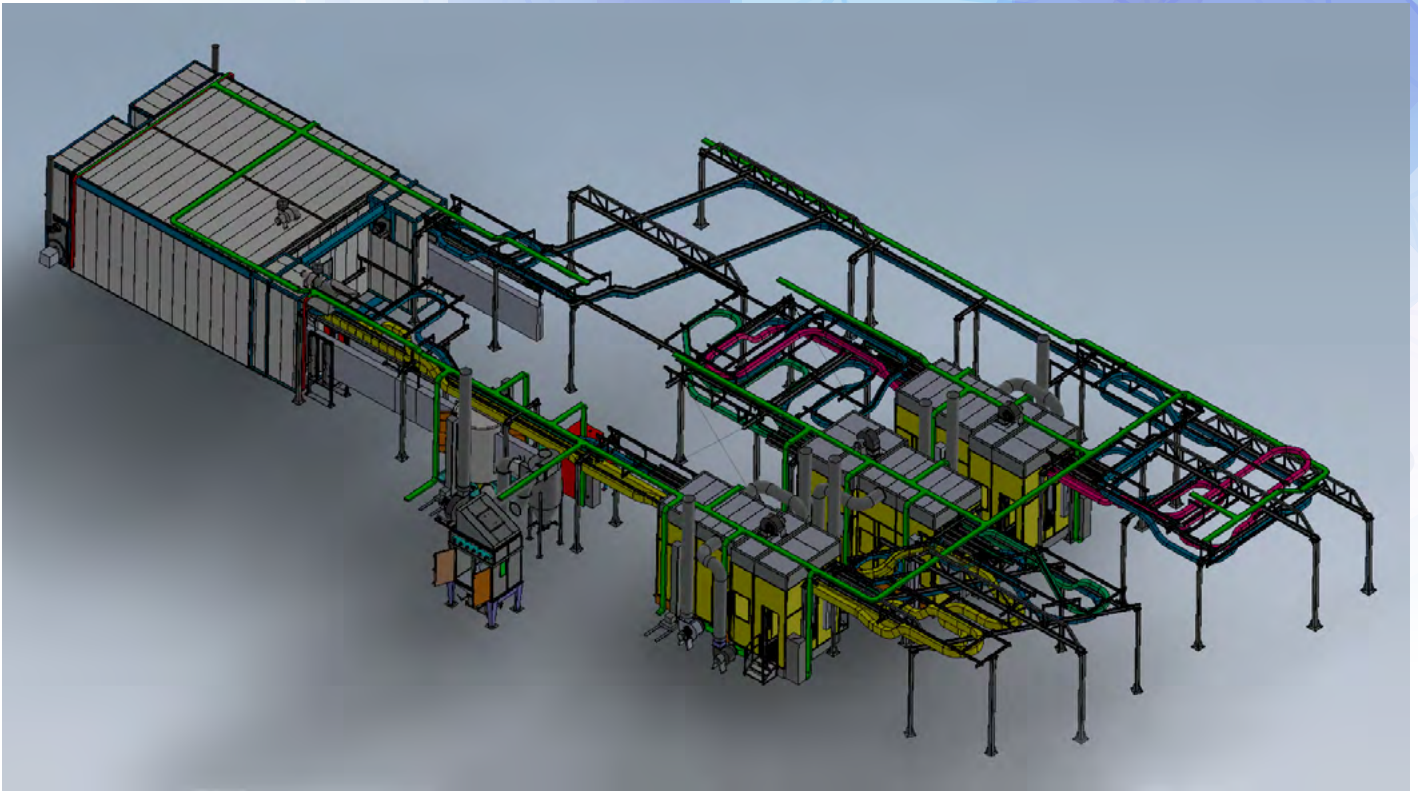

SEF ITALIA is well aware that every customer boasts a different , precious experience when it comes to liquid or spray coating and the related equipments. So SEF ITALIA is open to install spray guns and other critical parts upon the customer request. The only goal is to make everything work in quality and cost efficiency.

For powder coating plants, we are proud to use our patented technology **MAGICDISC®** that includes a self cleaning booth that is able to automatically clean in few minutes. It goes without saying that this feature does not impact on the footprint request. All the parts to be coated are transported with a twin-rail automated overhead conveyor.

Thanks to this solution, it is possible to adjust speed, transit time and stand-by positions of several racks simultaneously. All components are controlled by an electronic system that controls all the requested process parameters , making the whole process stable and repeatable over and over in time.

It is possible to plug-in the plant with in-line chemical pre-treatments, so that the material receives little or no handling ,maximizing the coating cleanliness and brightness, making it ready for the highest quality painting.

**INCREASE YOUR BUSINESS TURNOVER, NOT THE FOOTPRINT OF YOUR COATING PLANT!**

# SUBLIMATION EQUIPMENTS & PLANTS



*SEF ITALIA has been producing, over the last twenty years, the most performing, user friendly and top-reliable machines for the the sublimation of coated metals.*

SEF ITALIA range of plants for aluminium decoration include the **Speedy** machines, whose performance can be furtherly powered up with

additional equipments in order to increase the productivity and reduce the necessary workforce, without compromising the quality!

## Stillwood® plants technical features

NAME	EQUIPMENT	PRODUCTION RATE	REQUIRED SPACE	REQUIRED MANPOWER
<b>PRESSES</b>	Manual equipment	6 pcs/h	4,6 x 3,3 x h 2 m * 15 x 11 x 7 ft *	2 workers
<b>PRESTIGE SMART</b>	Heat transfer oven	20-40 prof./h	11 x 6.5 x h 1,9 m 36 x 21 x h 6 ft	2 workers
<b>BG-60</b>	Bagging machine	60 prof./h	8,5 x 1,4 x h 0,92 m 28 x 5 x h 3 ft	2 workers
<b>PRESTIGE</b>	Heat transfer oven	30-60 prof./h	11 x 6.5 x h 1,9 m 36 x 21 x h 6 ft	2-4 workers
<b>SPEEDY E (with BG-60)</b>	Semi-automatic equipment	60-70 prof./h	10 x 10 x h 2,5 m 33 x 33 x h 8 ft	4-5 workers
<b>SPEEDY E</b>	Automatic equipment	80-90 prof./h	19.5 x 11 x h 2,7 m 64 x 36 x h 9 ft	5 workers
<b>SPEEDY 3</b>	Automatic equipment	120-180 prof./h	22 x 11 x h 2,85 m 72 x 36 x h 9 ft	5 workers

\* Depending on the sheet dimensions

# Presses - PL 2210

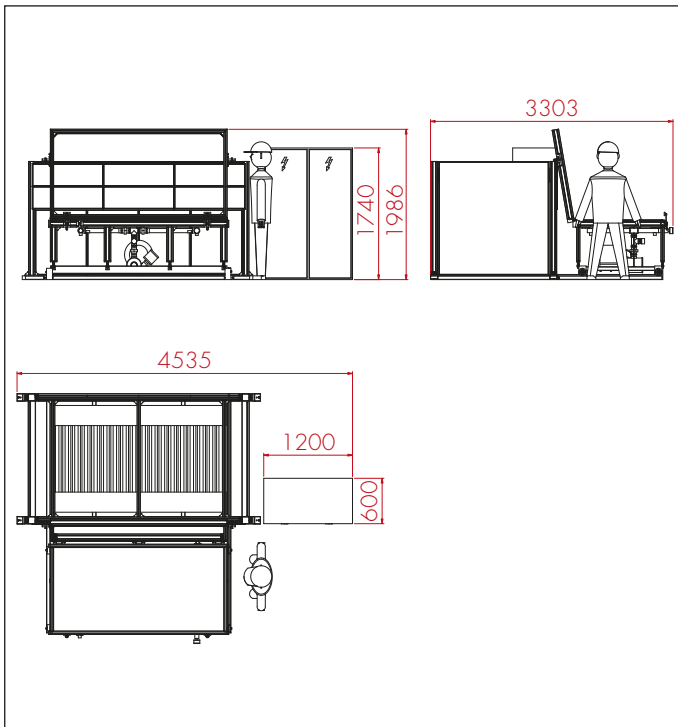

## Specifications

Metal sheet dimensions	2200 x 900 mm 559 x 229 in
Electric power installed	41 Kw
Air consumption	5 NI/h @ 6 bar
Weight	2500 Kg

# Prestige Smart

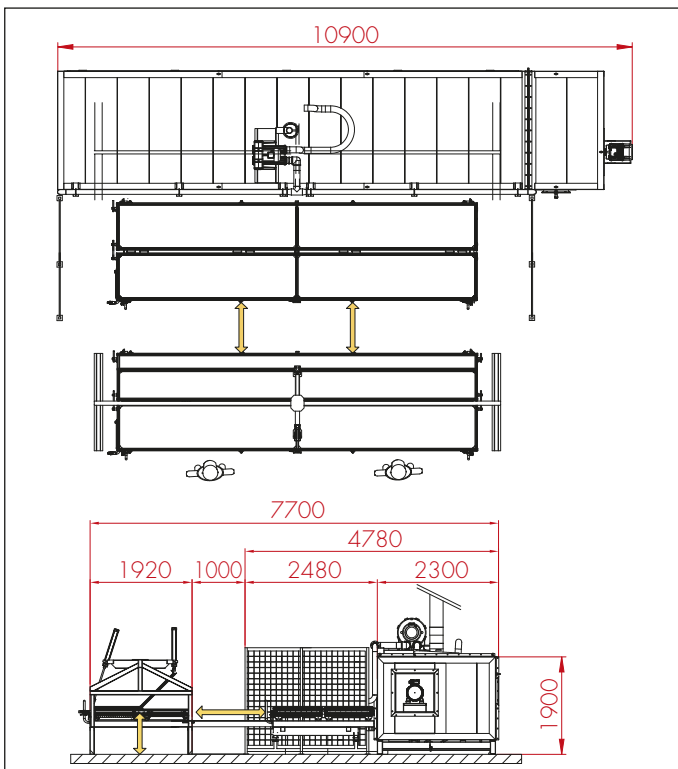

## Specifications

Profile dimensions	7350 x 150 x 400 mm 289.4 x 5.9 x 15.7 in
Metal sheet dimensions	2200 x 900 mm 559 x 229 in
Electric power installed	25 Kw
Air consumption	20 NI/ @ 6 bar
Natural gas / GPL installed power	200 Kw/h
Weight	8000 Kg

# BG-60 - bagging machine

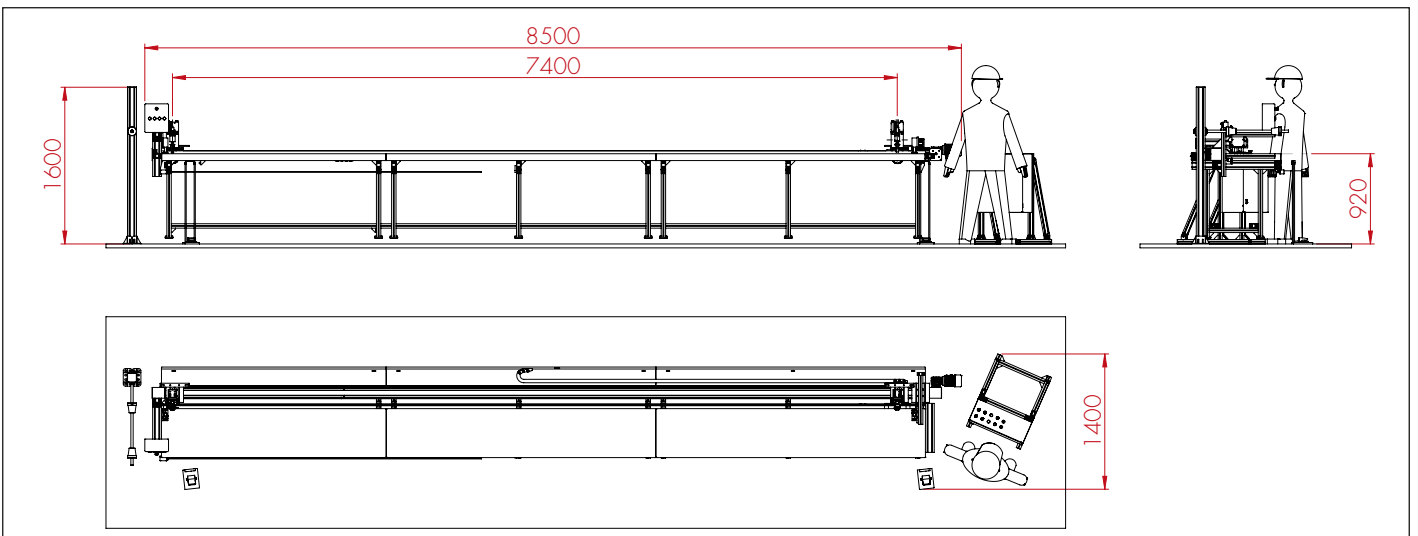
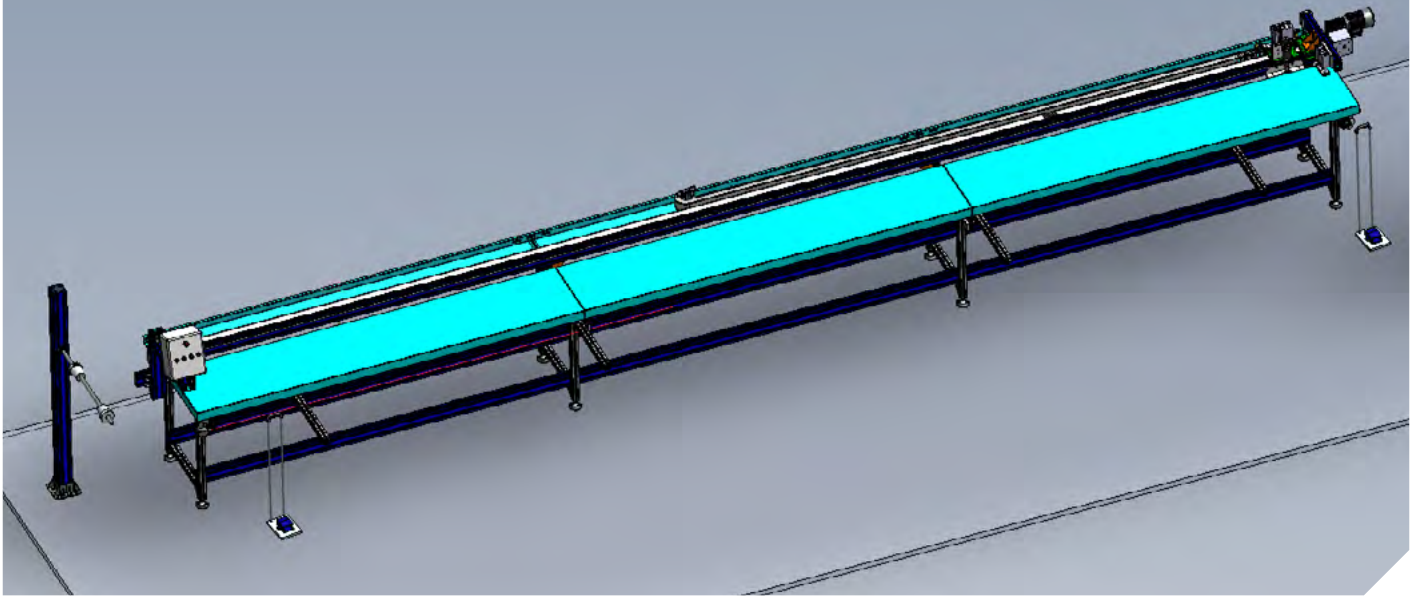

## Specifications

Profile dimensions	7000 x 150 x 400 mm 275.6 x 5.9 x 15.7 in
Electric power installed	2 Kw
Air consumption	5 NI/h @ 6 bar
Film spool dimensions	Ø 250 mm - width: 700 mm Ø 9.8 in - width: 27.6 in
Weight	1000 Kg

# Prestige - heat transfer oven

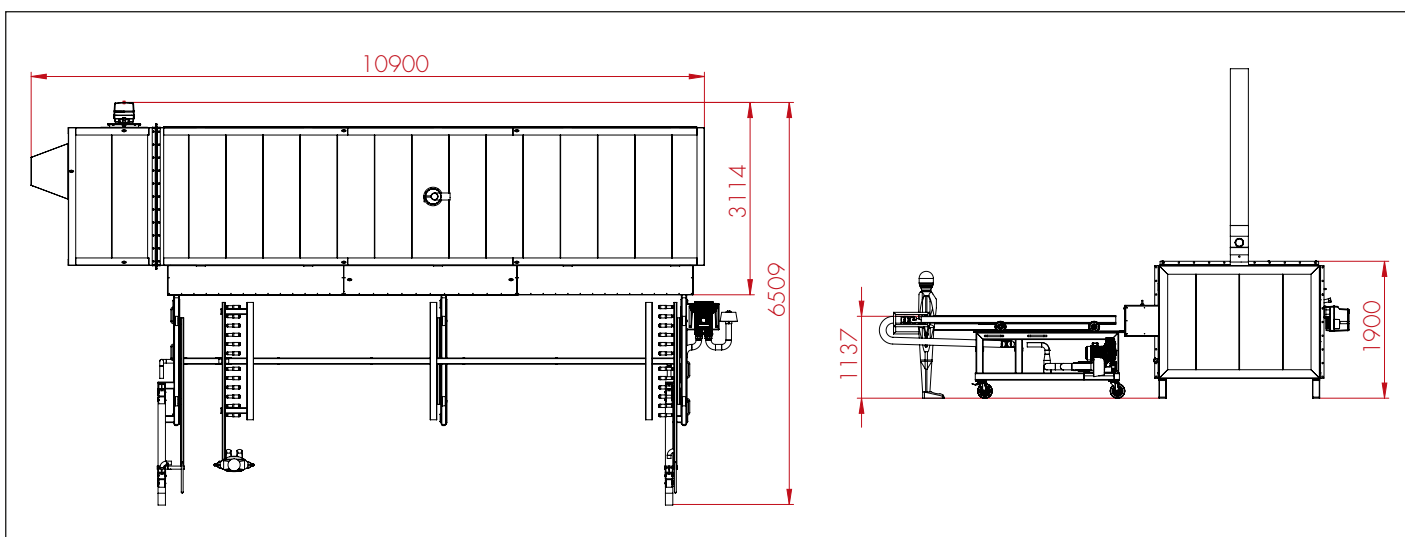

## Specifications

Profile dimensions	7350 x 150 x 400 mm 289.4 x 5.9 x 15.7 in
Electric power installed	25 Kw
Air consumption	20 NI/ @ 6 bar
Natural gas / GPL installed power	200 Kw/h
Weight	7000 Kg

# Speedy E

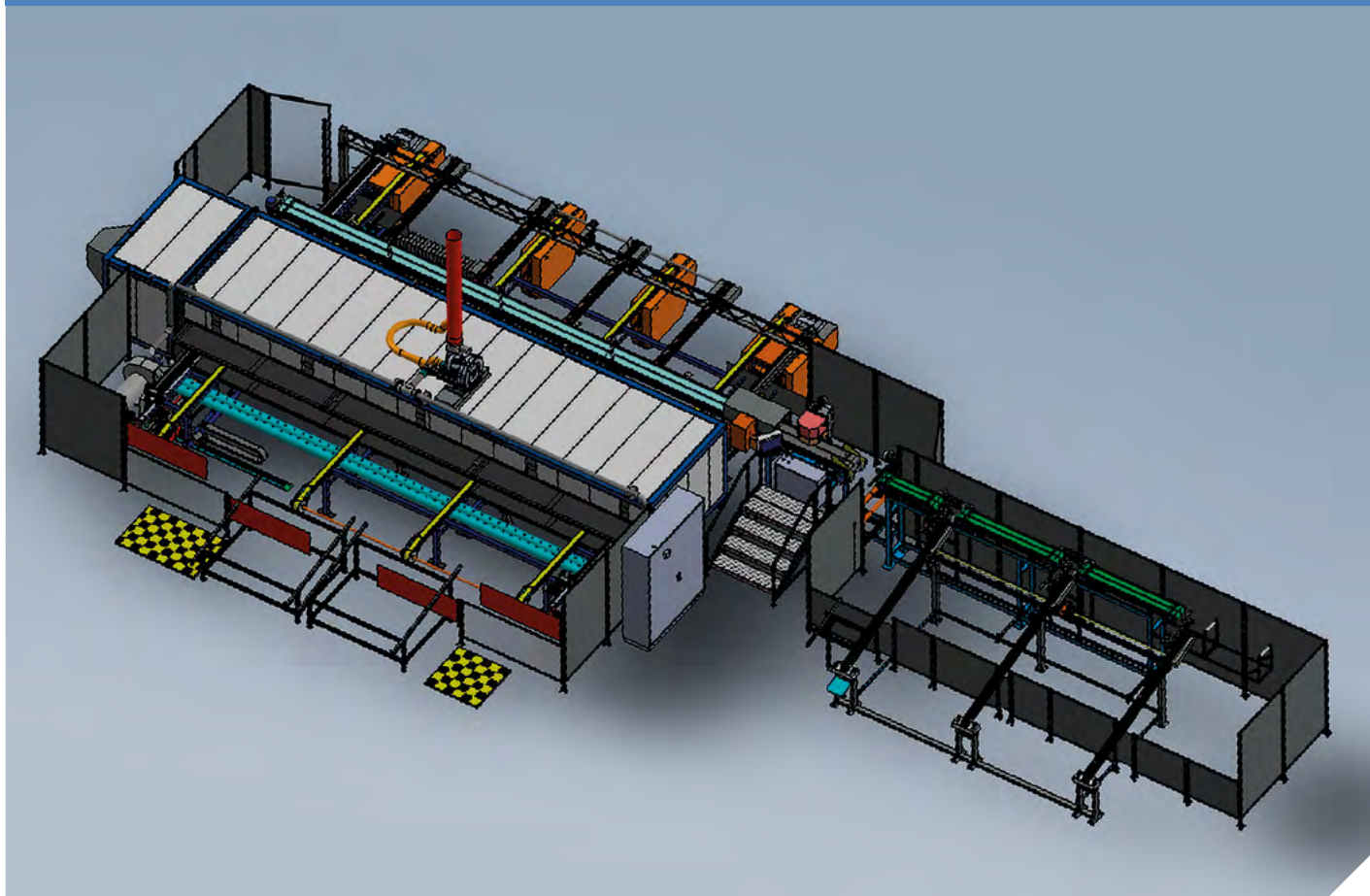

## Specifications

Profile dimensions	7350 x 150 x 400 mm 289.4 x 5.9 x 15.7 in
Electric power installed	Sublimation oven: 40 Kw; bagging machine: 5 Kw
Air consumption	2000 NI/h @ 6 bar
Natural gas / GPL installed power	200 Kw/h
Weight	Sublimation oven: 10000 Kg; bagging machine: 1200 Kg

# Speedy E

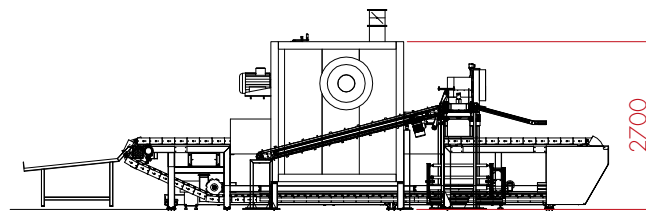
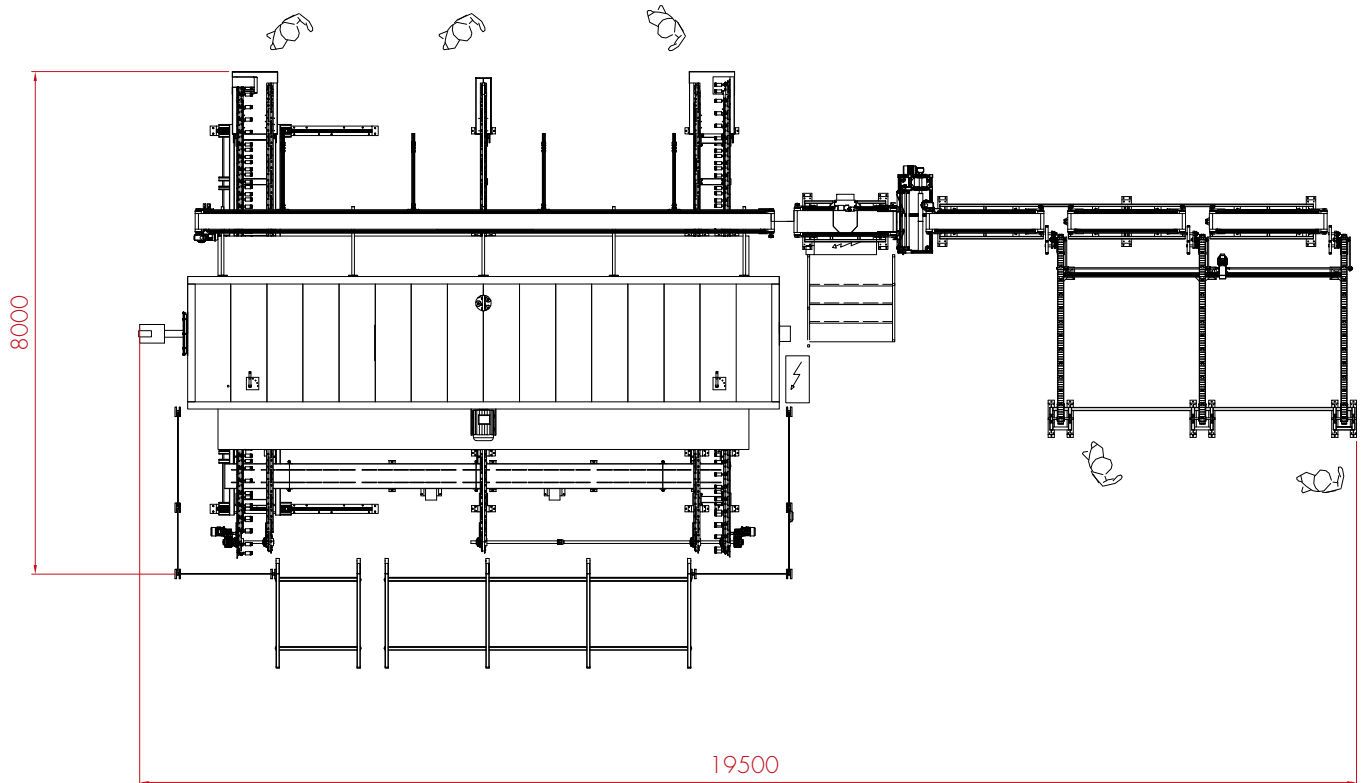

# Speedy 3

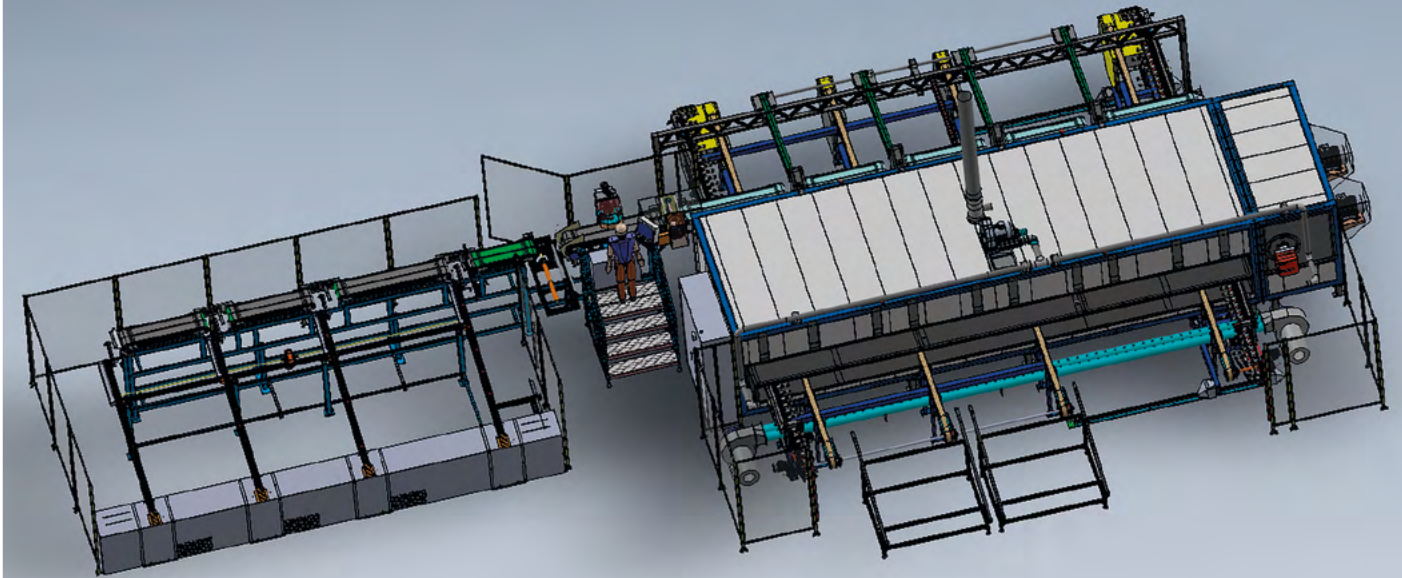

## Specifications

Profile dimensions	7350 x 150 x 400 mm 289.4 x 5.9 x 15.7 in
Electric power installed	Sublimation oven: 45 Kw; bagging machine: 5 Kw
Air consumption	2000 NI/h @ 6 bar
Natural gas / GPL installed power	200 Kw/h
Weight	Sublimation oven: 10000 Kg; bagging machine: 1200 Kg



# Speedy 3

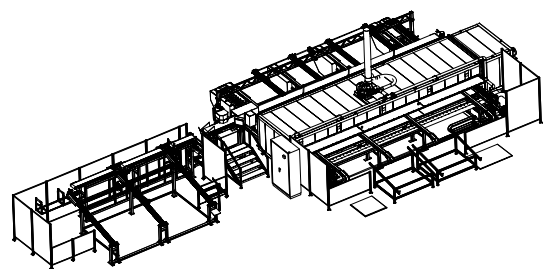
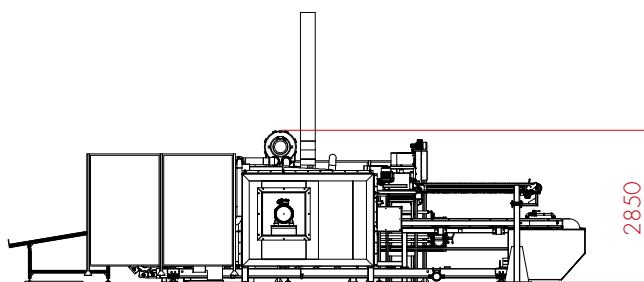
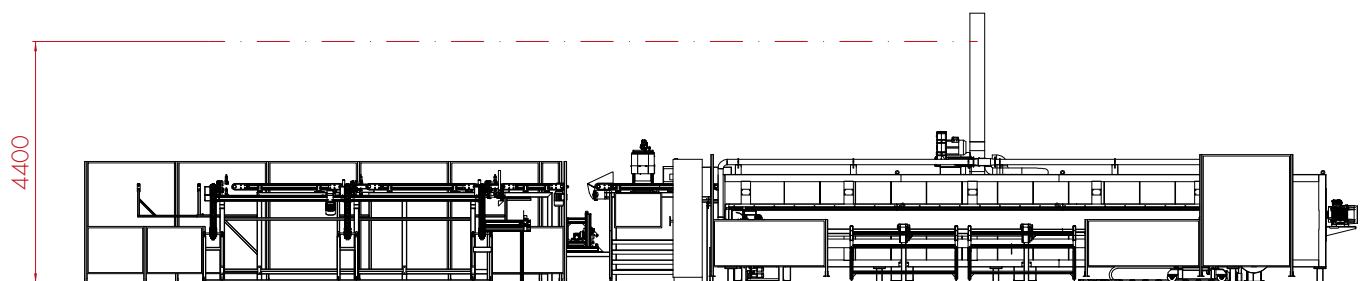
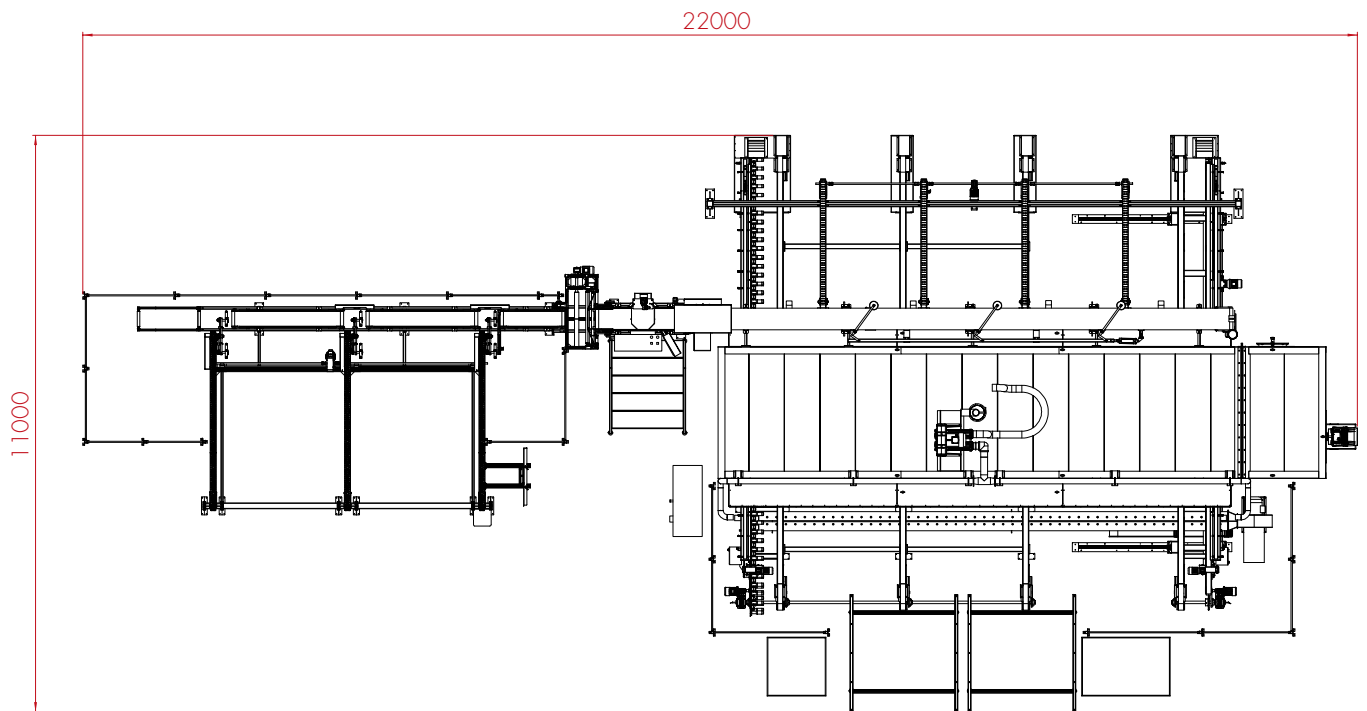

# CUSTOMIZED PLANTS

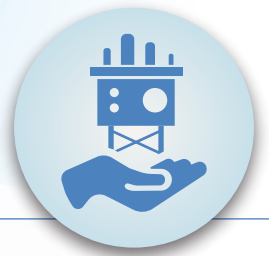

*SEF ITALIA loves to face the challenges that today's market generate. Design innovation and the total commitment towards the customer's needs has always been the key features of SEF technical team. SEF has developed tailored solutions for many multinational companies, because the best products need the best machinery for their production!*





# WITH THE RIGHT PARTNER YOU CAN BUILD AN EMPIRE.

SEF ITALIA 

**MENPHIS**<sup>®</sup>

---

**SEF ITALIA** is the Italian company that has brought sublimation technology to always new levels since its foundation, twenty years ago. Our commitment to process reliability and customer's satisfaction has never been disappointed: we're internationally recognized as the best machinery manufacturer for sublimation.

**MENPHIS** is a forward-looking company that has successfully developed and expanded its know-how in the field of sublimation films and sublimation powders, thanks to a strong innovative vision. Memphis is currently the biggest European producer of sublimation film for aluminum, with a production area of 30,000 square meters - entirely located in Italy - and exports to over 80 different countries.

---

***MENPHIS and SEF ITALIA are now together in the market to provide turn-key solutions for the demanding coating and sublimation industry.***



The  
United  
States  
of  
America



**The Director of the United States  
Patent and Trademark Office**

*Has received an application for a patent for a new and useful invention. The title and description of the invention are enclosed. The requirements of law have been complied with, and it has been determined that a patent on the invention shall be granted under the law.*

*Therefore, this*

**United States Patent**

*Grants to the person(s) having title to this patent the right to exclude others from making, using, offering for sale, or selling the invention throughout the United States of America or importing the invention into the United States of America, and if the invention is a process, of the right to exclude others from using, offering for sale or selling throughout the United States of America, or importing into the United States of America, products made by that process, for the term set forth in 35 U.S.C. 154(a)(2) or (c)(1), subject to the payment of maintenance fees as provided by 35 U.S.C. 41 (b). See the Maintenance Fee Notice on the inside of the cover.*

*Lucia Street Keu*

Acting Director of the United States Patent and Trademark Office

# CERTIFICATES & MEMBERSHIPS



**Powder Coating Institute**  
<https://www.powdercoating.org/>



**Axa**  
<https://www.axa.com/>



**Qualideco**  
<http://www.qualideco.eu/>



**Qualicoat**  
<https://www.qualicoat.net/>



AAMA + IGMA  
*by Memphis*



**Oeko-Tex**  
<https://www.oeko-tex.com/>



**Fenestration & Glazing  
Industry Alliance**  
<https://fgiaonline.org/>

# WHERE WE ARE



SEF ITALIA 



**MENPHIS**<sup>®</sup>



**S.E.F. ITALIA s.r.l.**

Via della Valle 46/A - 20841 – Carate Brianza (MB)  
Phone: +39 0362 805 575 - Fax: +39 0362 975 175  
[www.sefitalia.net](http://www.sefitalia.net) - [sefitalia@sefitalia.net](mailto:sefitalia@sefitalia.net)

**MENPHIS S.p.a.**

Via Adige, 9 - Casnate con Bernate (CO) - ITALY  
Phone: +39 031 566 333 - Fax: +39 031 566 3395  
[www.menphis.eu](http://www.menphis.eu) - [info@menphis.com](mailto:info@menphis.com)





**S.E.F. ITALIA s.r.l.**

Via della Valle 46/A - 20841 - Carate Brianza (MB)  
Phone: +39 0362 805 575 - Fax: +39 0362 975 175  
[www.sefitalia.net](http://www.sefitalia.net) - [sefitalia@sefitalia.net](mailto:sefitalia@sefitalia.net)

**MENPHIS S.p.a.**

Via Adige, 9 - Casnate con Bernate (CO) - ITALY  
Phone: +39 031 566 333 - Fax: +39 031 566 3395  
[www.menphis.eu](http://www.menphis.eu) - [info@menphis.com](mailto:info@menphis.com)